

- Note:
- *1. LCD Display Type: TFT.Transmissive
 - *2. Pixel Arrangement: RGB-SPRIPE
 - *3. Operating Voltage : 3.3V
 - *4. Backlight Supply (K2) : 5.0V
 - *5. Backlight : LEDs
 - *6. Color Depth : 262K colors
 - *7. Operating Temperature : -10°C~60°C
 - *8. Storage Temperature : -20°C~70°C
 - *9. K2: 6Pin, P2.0, JST B6B-PH-K-S or equivalent

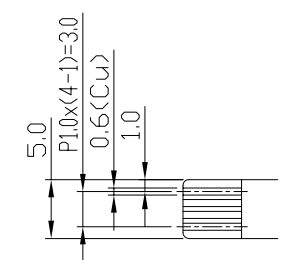

Touch Panel FPC Terminals Details (Conductor Side) Scale=free

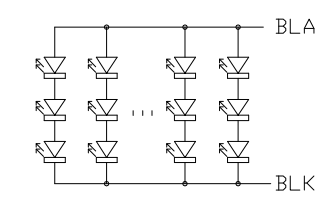

Backlight Circuit (No. of LEDs = 3x10pcs) Scale=free

Touch Panel Logic Details Scale=free

C		
B		
A		
Rev	Note	Date
	LMT057DCDFWU-NBA Outline Dwg	
Dwg No.	MK-003607-1-1	Date
		2011-04-09
Scale	Tol. ±0.5	Unit mm
3/4		Paper Size A3
Approved	Checked	Drawn Yang Lin

K1 Terminal No	Pin Name	K2 Terminal No	Pin Name
1	DGND	1	BLVCC
2	DCLK	2	BLVCC
3	HSYNC	3	BLON
4	VSYNC	4	BLADJ
5	GND	5	BLGND
6	R0	6	BLGND
7	R1		
8	R2		
9	R3		
10	R4		
11	R5		
12	GND		
13	G0		
14	G1		
15	G2		
16	G3		
17	G4		
18	G5		
19	GND		
20	B0		
21	B1		
22	B2		
23	B3		
24	B4		
25	B5		
26	GND		
27	DN		
28	VCC		
29	VCC		
30	LRC		
31	UDC		
32	NC		
33	GND		

info@topwaydisplays.eu
www.topwaydisplays.eu

TOPWAY